

ABByTM

Quick Reference Guide

OBSTETRICS, GYNAECOLOGY & NEONATAL
ABBy retracts the panniculus off the incision site after lower abdominal surgery.

1. Preparation



Patient is in supine or "laying down" position and holds up pannus.

2. Remove tab 'A'

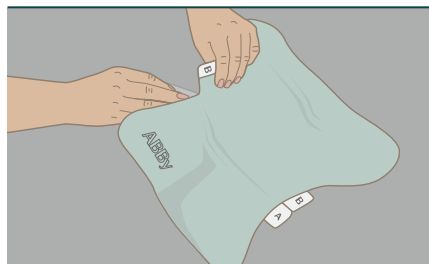

While in a flat or reclining position, grab each top corner.

3. Position & Apply Tab A



Align and adhere bottom of ABBY 3-5 cm above incision. Smooth panel A down to the skin.

4. Remove Tab B

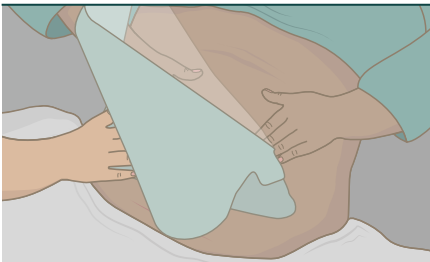

At the top corners, place your fingers on the outside and your thumbs on the silicone adhesive inner side of the ABBY.

5. Retract & Apply Tab B

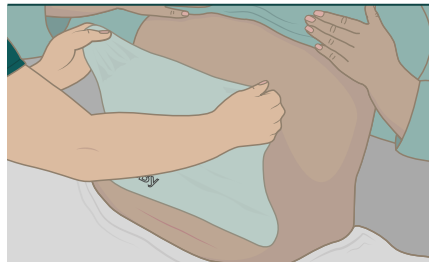

Holding ABBY at the top of each corner, gently pull towards the head and affix top edge at the bottom of the sternum.

6. Finish Application



Make sure there are no wrinkles in the retractor and smooth ABBY down entirely to skin.

See Instructions for Use for full instructions, warnings, precautions and contraindications.

© 2024 Laborie. All rights reserved.

ABByTM
Postoperative Panniculus Retractor

